

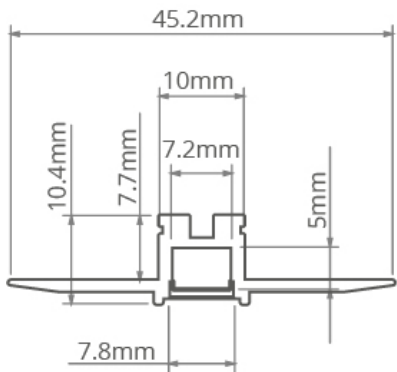

KOZEL-10 PROFILE P/M
C1575ANODA_1
RAW ALUMINIUM
Remote CONTROL GEAR REMOTE
IP20
VOLTAGE: 12V, 24V

Very small size (fits in a slot 8 mm deep by 12 mm wide) Possibility to use the TECH-10 protective insert to protect the interior of the extrusion from contamination during construction work Clean installation of a LED strip Lighting fixtures can be combined into long runs using ZM connectors



Accessories	
42716	CONNECTOR ZM 90
42719	CONNECTOR ZMPION 135
42718	CONNECTOR ZMPION 90